

The Cliff ord Soergel Memorial Outreach Garden is roughly one-third of an acre and is located within the much larger Kubecka Community Garden. The Soergel Garden is managed by the Town's Department of EWM and maintained by the Department of General Services in conjunction with volunteer gardeners from the site.

The Soergel Garden is a memorial to Cliff ord Soergel a long-t me Kubecka gardener at the site who established, maintained and managed this "garden within a garden" with the explicit mandate that the garden beds were free of charge, but half of the produce grown on each bed would be donated to local food banks to feed the needy.

- RAISED GARDEN BEDS:**
- M-1 THROUGH M-9
 - R-1 THROUGH R-20
 - X-1 THROUGH X-3
- GROUND LEVEL GARDEN BEDS:**
- A-1 THROUGH A-5
 - B-1 THROUGH B-5
 - C-1, D-1, E-1, F-1
 - L-1 THROUGH L-3
 - M-10 AND M-11

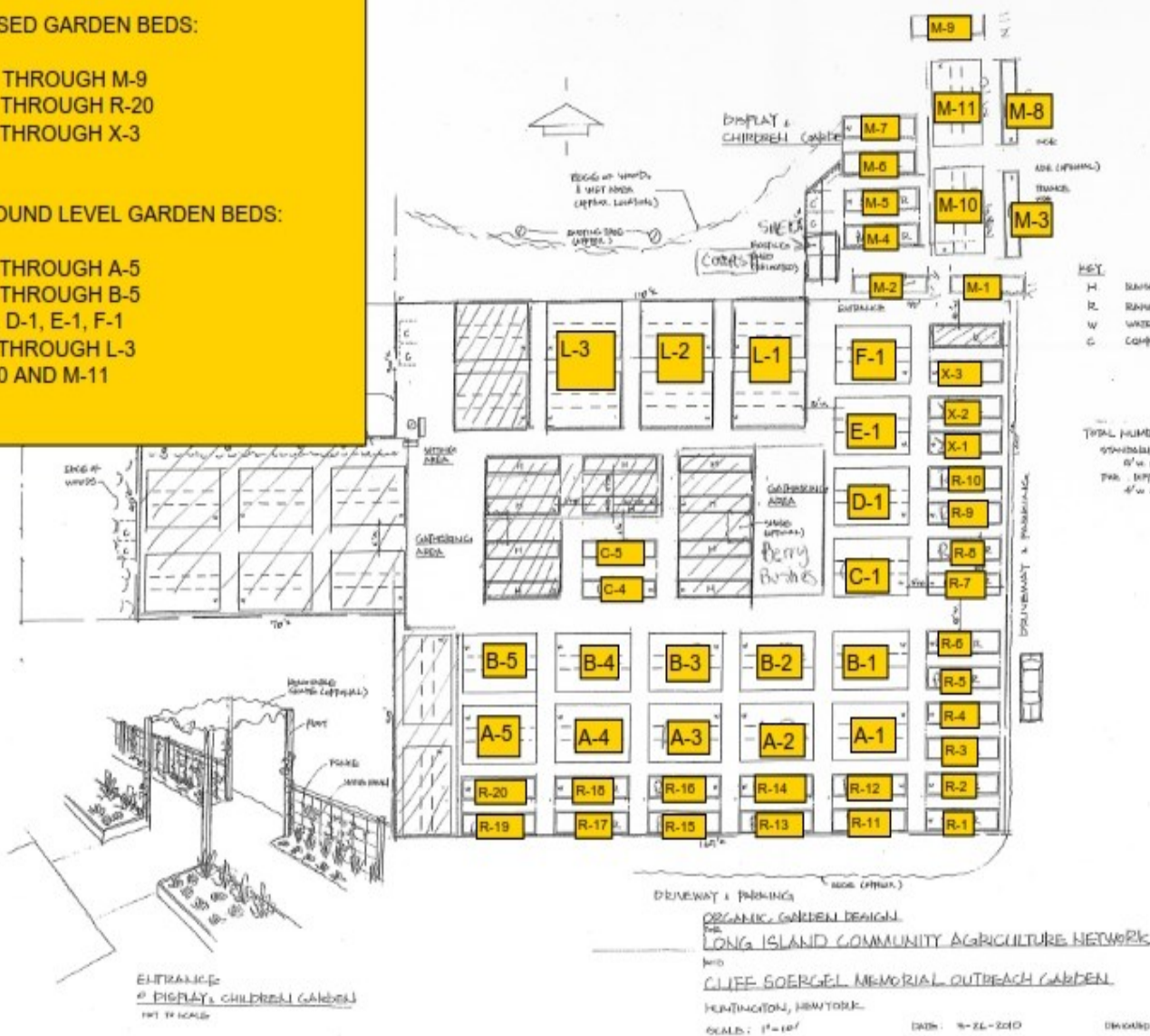

- KEY:**
- H RAISED BED (OR DIFFERENTIABLE)
 - R RAISED BED
 - W WATER TAP
 - C COMPOST BIN

TOTAL NUMBER OF BEDS:

- 8' x 30' L. — 84
- 4' x 30' L. — 12

ORGANIC GARDEN DESIGN
 FOR THE
 LONG ISLAND COMMUNITY AGRICULTURE NETWORK
 AND
 CLIFF SOERGEL MEMORIAL OUTREACH GARDEN
 HUNTINGTON, NEW YORK
 SCALE: 1" = 10'
 DATE: 9-21-2010
 DRAWING BY: VORHUTLAND